

REFER TO DRAWING D-06C-365A/D-06C-366A FOR FRONT/REAR AND TOP LAYOUT VIEWS.

NOTE: *ESTIMATED DIMENSIONS. MEASUREMENTS DEPEND ON CHASSIS, TIRES, SPRINGS, AND LOADING.

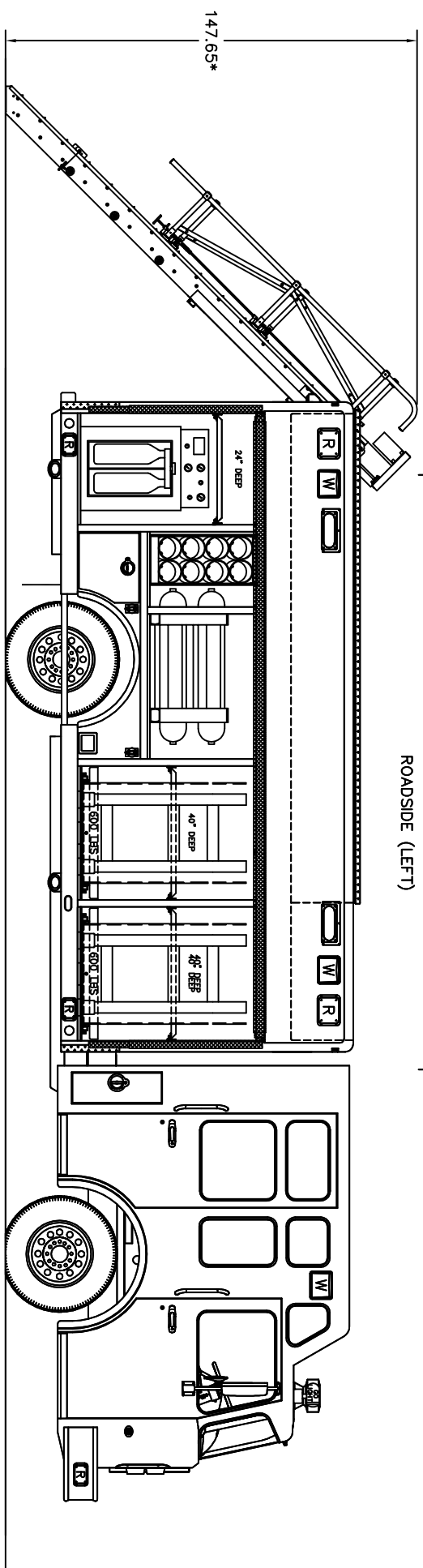
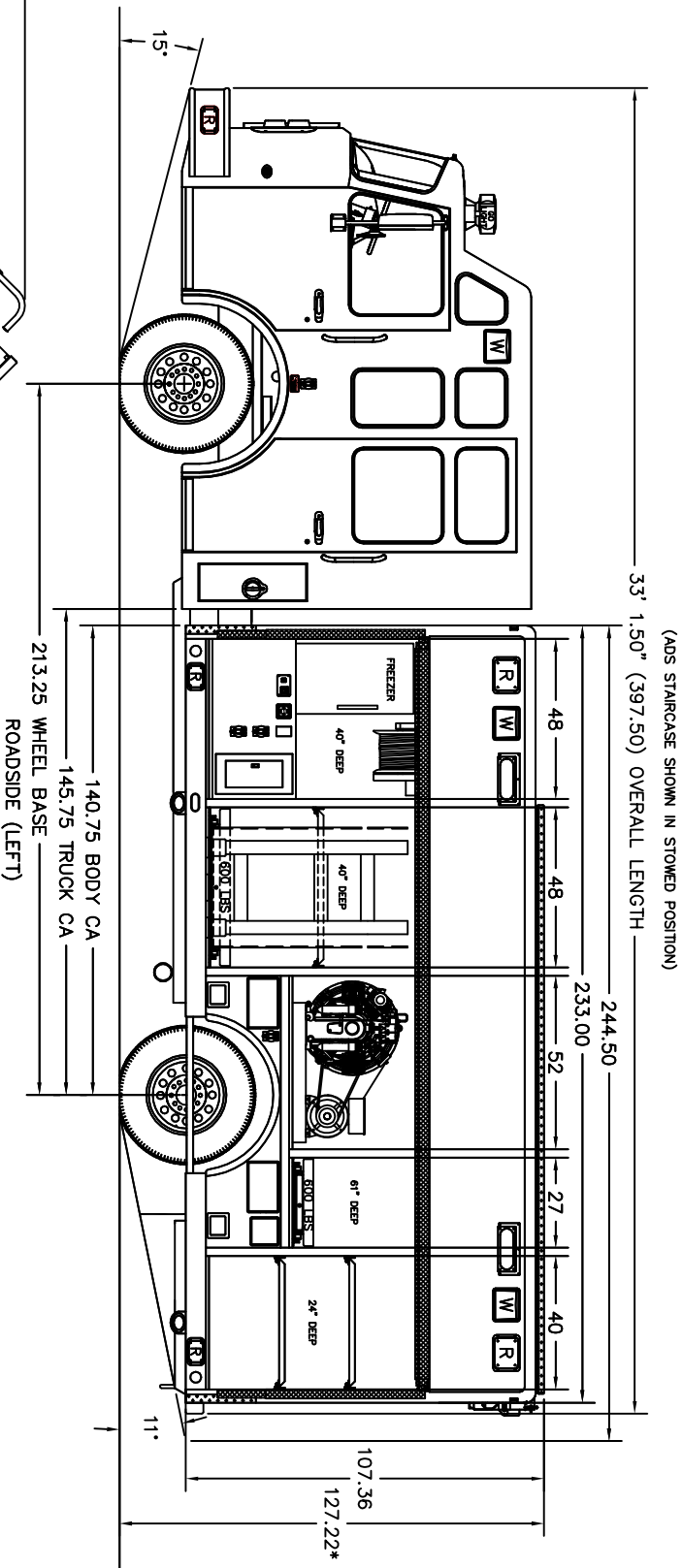

*** ORIGINAL ***

THIS PRINT AND ALL RIGHTS TO THE DESIGN AND DETAIL THEREON ARE THE PROPERTY OF HACKNEY, WASHINGTON, N.C. AND IS LOANED TO THE RECIPIENT SUBJECT TO RETURN UPON DEMAND. ITS CONTENTS ARE CONFIDENTIAL AND MUST NOT BE COPIED OR SUBMITTED TO OUTSIDE PARTIES FOR USE OR EXAMINATION.

CUSTOM DESIGNED FOR:
 #06F20015
 SEATTLE FIRE DEPARTMENT
 SEATTLE, WA

7/28/06	A	REVISED PER PO FROM SEATTLE FD	KMB	KMB
DATE	SYMBOL	REVISION RECORD	AUTH	DEFT.
UNLESS OTHERWISE SPECIFIED DIMENSIONS ARE IN INCHES TOLERANCES ON: 2 PL. DIMENSIONS ± ANGLES ± FRACTIONS ±				
DRAWN BY AND		DATE 05-20-06	EMERGENCY VEHICLES DIVISION WASHINGTON, NC 27889-0890	
APPROVED BY DATE		MODEL: DFC1164R	RTX	64/39
SUPERSEDES		SCALE	WASHINGTON, NC	
SUPERSEDED BY		1=30	D-06C-362A	

© 2006 HACKNEY
 A Division of SVC