

REAR COMPLEMENT HEIGHTS:
 42'-7 1/2" x 10'-5 1/2" x 18'-1 1/2"
 42'-7 1/2" x 12'-5 1/2" x 18'-1 1/2"
 42'-7 1/2" x 10'-5 1/2" x 18'-1 1/2"
 42'-7 1/2" x 10'-5 1/2" x 18'-1 1/2"
 42'-7 1/2" x 9'-0 1/2" x 10'-0"
 42'-7 1/2" x 9'-0 1/2" x 10'-0"

TIRES, SPRINGS, AND LOADING.
 MEASUREMENTS DEPEND ON CHASSIS,
 NOTE: *ESTIMATED DIMENSIONS.

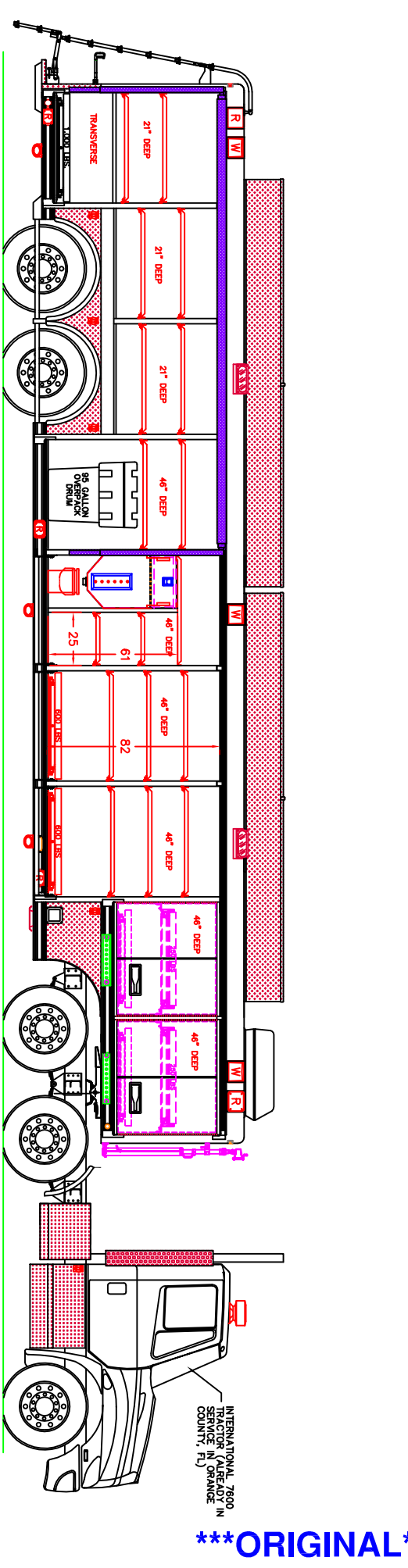
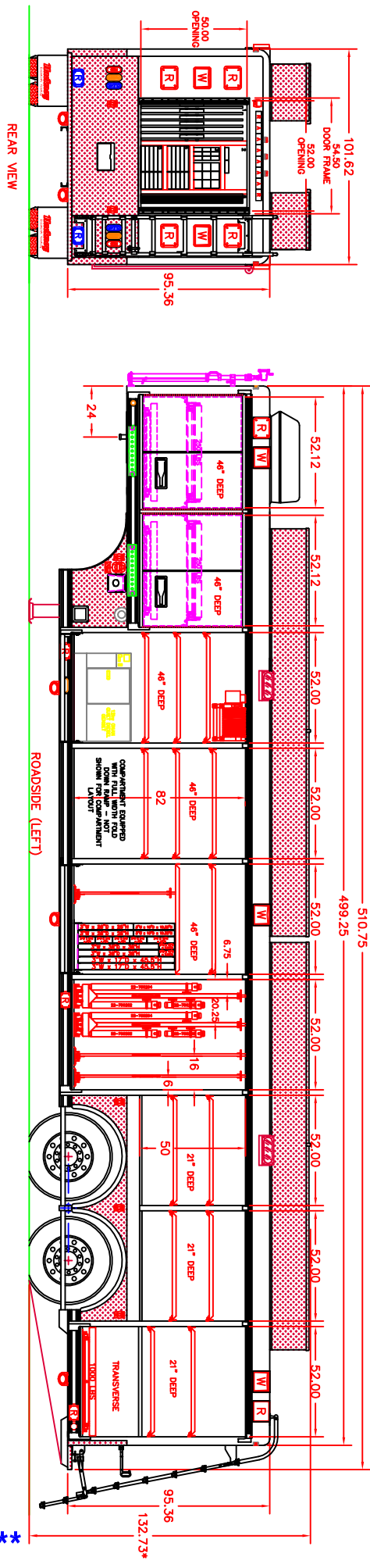

*** ORIGINAL ***

THIS PRINT AND ALL RIGHTS TO THE DESIGN AND DETAIL THEREON ARE THE PROPERTY OF HACKNEY, WASHINGTON, N.C. AND IS LOANED TO THE RECIPIENT SUBJECT TO RETURN UPON DEMAND. ITS CONTENTS ARE CONFIDENTIAL AND MUST NOT BE COPIED OR SUBMITTED TO OUTSIDE PARTIES FOR USE OR EXAMINATION.

CUSTOM DESIGNED FOR:

08F09294
 ORANGE COUNTY FIRE RESCUE
 ORLANDO, FL

DATE	SYM	REVISION RECORD	AUTH/DRAFT.
4/6/09	A	REVISED PER CHANGE ORDER 3336	KMB
UNLESS OTHERWISE SPECIFIED TOLERANCES ARE IN INCHES DIMENSIONS ON: 3 PL. DECIMALS ± ANGLES: 2			
DESIGNED BY	DATE	MODEL:	ORANGE, FL
TRUCKING	9/11/08	3-EST-19	UTX 82/50
APPROVED BY/DATE		SCALE	
KMB		1=36	D-08C-642A
EMERGENCY VEHICLES DIVISION WASHINGTON, NC 27888-0880			

© 2008 HACKNEY
 A Division of VT-SVC